

Pillow Case Folder, boarder a cross

Type White Sapphire

espritech GmbH • Gislernen 2 • CH-3266 Wiler bei Seedorf
Switzerland

espritech

The **White Sapphire** folding machine is for the folding and stacking of pillow cases and other flat products - woven, non woven, non-elastic flat pieces.

This installation is a stand - alone unit. The folding machine is able to work up various material types including cotton, sateen, mixture fabric, polyester/cotton and flannel.

The feeding edges of the pieces are shown as outside fold or hidden as inside fold.

The system is equipped with a cardboard inserting device for standard and book fold folding.



Feeding size:

(Additional sizes on request)

- W = 304 mm - 1000 mm (12 - 39")
- L = 304mm - 1,100 mm (12 - 44")

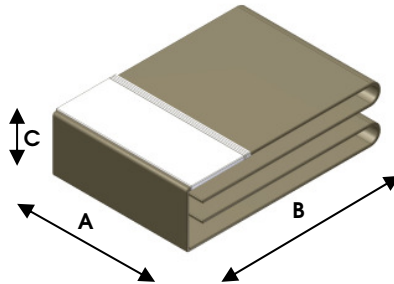

Folding size:

(Additional sizes on request)

- A = 100 mm - 304 mm (4 - 12")
- B = 100 mm - 304 mm (4 - 12")
- C = Gusset up to 76 mm (3")

Production:

- One operator for manual feeding
- Up to 1440 pieces / h
- Up to 17 pieces/minute with single pillow cases
- Up to 24 pieces/minute pillow case folding (12 pairs/minutes)

Modules:

- In feed table
- Transfer & synchronizing pair folding
- Cross fold A (by reversing & air blast)
- Lateral fold A (by sliders & templates)
- Cardboard inserter
- Lateral fold B (by slider & template)
- Cross fold B (swing arm)
- Cross fold C (by swing arm)
- Cross fold D (by reversing & folding knife)
- Stacker

Folding pattern:

- Top fold (visible boarder)
- Inside fold (hidden boarder)
- Pair top fold (two item in one bag)
- Pair inside fold (two item in one bag)



Book fold
Boarder a cross

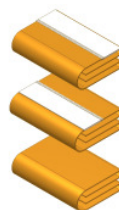

Standard fold
Boarder a cross

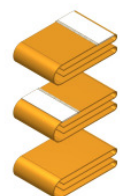

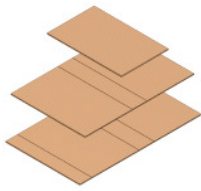

Cardboard type & sizes:

- (Additional sizes on request)
- Maximum width 304 mm (12")
 - Minimum width 102 mm (4")
 - Maximum length 610 mm (24")
 - Minimum length 102 mm (4")
 - Height of gusset max. 76 mm (3")
 - Magazine load up to 405 mm (16")

All cardboards will be folded to the very inside of the fabric, non visible

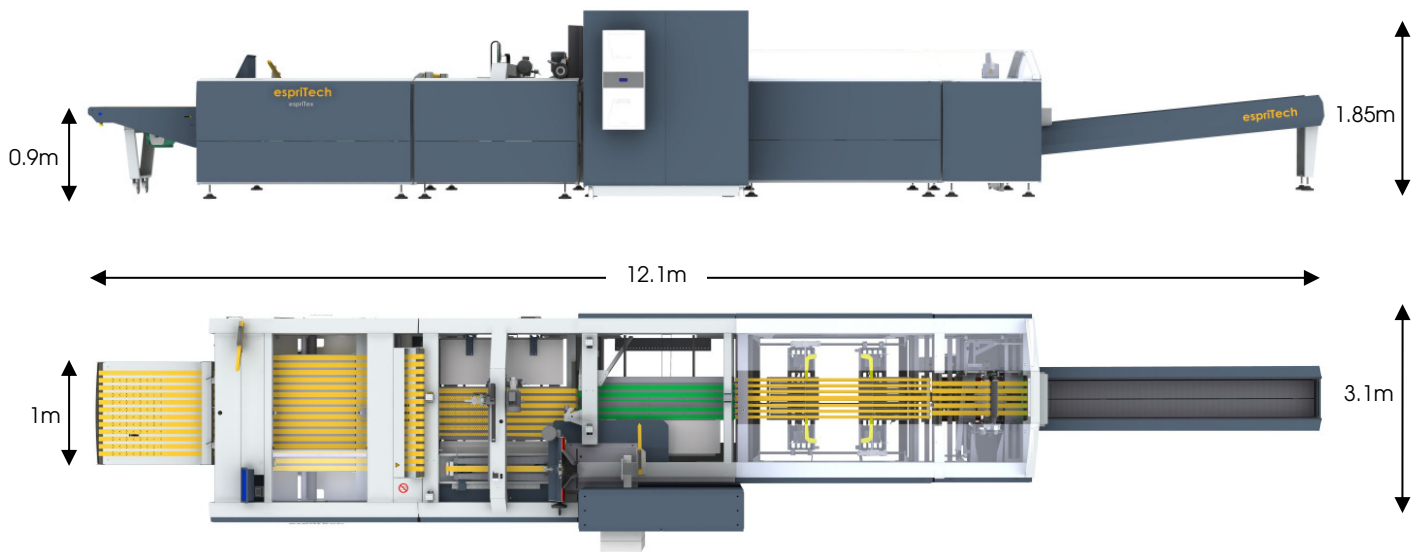
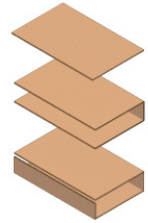

Technical data:

- 230/400V 50/60Hz, 3 phases/N/PE, approx 7kW
- Compressed air 6Bar/87psi
- 110 l/min air consumption

Control system:

- Beckhoff TwinCAT, PC- Windows
- 15" Touchscreen
- 40'000 program spaces
- Remote access integrated (Internet)

Options

- Cooling system
- Additional folding stations
- Rolloff stacking system
- Many other options on request

Business contact:

espritech

espritech GmbH
 Gisleren 2
 CH-3266 Wiler bei Seedorf
 Switzerland

www.espritech.ch
info@espritech.ch

T: +41 32 530 22 78
 F: +41 32 530 22 79

Manufactured by:

espritech

espritech GmbH
 Gisleren 2
 CH-3266 Wiler bei Seedorf
 Switzerland